



This document has been  
printed on ecological paper

# ***ASwich***

**Safety Is On**

Email: [contact@aswich.com](mailto:contact@aswich.com)  
Fax: +86-21-60250600

As standards, specifications and designs change  
from time to time, please ask for confirmation of the  
information given in this publication.

[www.aswich.com](http://www.aswich.com)

Aswich all rights reserved.

# Photovoltaic Fuse

Leading Manufacturer Protects Solar Power Safety

Rev1.0 2022/09/16



# PHOTOVOLTAIC FUSE

## 1500VDC/14×51 15A-15A



### Photovoltaic Fuse

- Fuse Size: 14 X 51mm
- Class of Operation: gPV
- Standard: GB/T 13539.6 IEC 60269-6
- Breaking Capacity: 20kA
- Time Constant: 1-3ms

### Dimensions(mm)

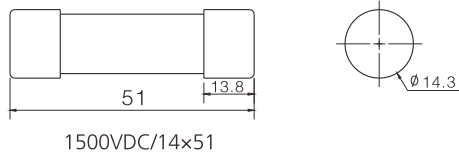

### Time current Curve

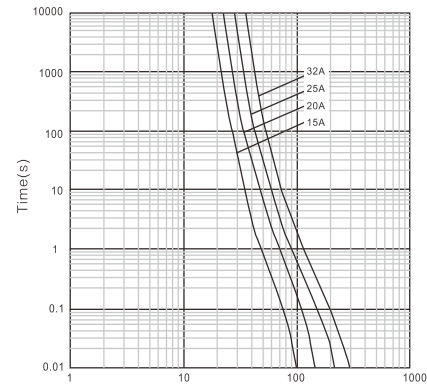

1500VDC/14×51 Prospective current(A RMS)

### Specifications

Model	Rated current	$I^2 T (A^2 S)$	
		Pre-arcing	Total
1500VDC/14×51/15A	15	330	275
1500VDC/14×51/20A	20	220	578
1500VDC/14×51/25A	25	275	956
1500VDC/14×51/30A	30	380	1160
1500VDC/14×51/32A	32	405	1830
1500VDC/14×51/40A	40	600	2430
1500VDC/14×51/50A	50	850	3050

## 1500VDC/14×51B/50A



### Photovoltaic Fuse

- Rated Voltage : 1500V DC
- Class of Operation: gPV
- Standard: GB/T 13539.6 IEC 60269-6

### Dimensions(mm)

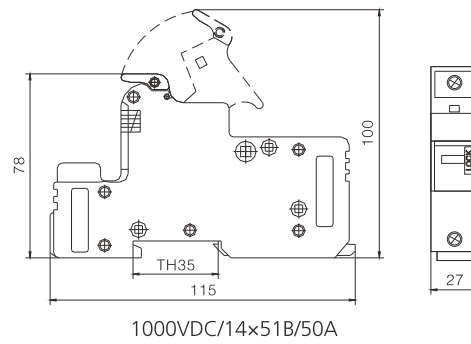

# PHOTOVOLTAIC FUSE

**1500VDC/22×58 30A-50A**



## Photovoltaic Fuse

- Fuse Size: 22 X 58mm
- Class of Operation: gPV
- Standard: GB/T 13539.6 IEC 60269-6
- Breaking Capacity: 20kA
- Time Constant: 1-3ms

## Dimensions(mm)

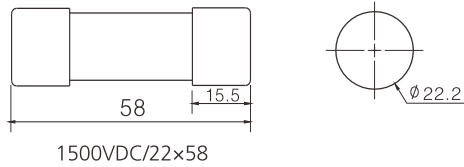

## Time current Curve

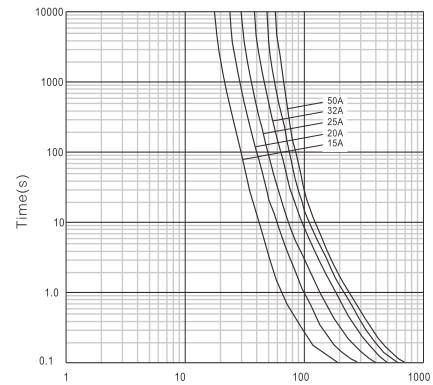

1500VDC/22×58 Prospective current(A RMS)

## Specifications

Model	Rated current	$I^2 T (A^2 S)$	
		Pre-arcng	Total
1500VDC/22×58/40A	40	750	3450
1500VDC/22×58/50A	50	1020	5050

## 1500VDC/22x58B/50A



### Photovoltaic Fuse

- Rated Voltage : 1500V DC
- Class of Operation: gPV
- Standard: GB/T 13539.6 IEC 60269-6

### Dimensions(mm)

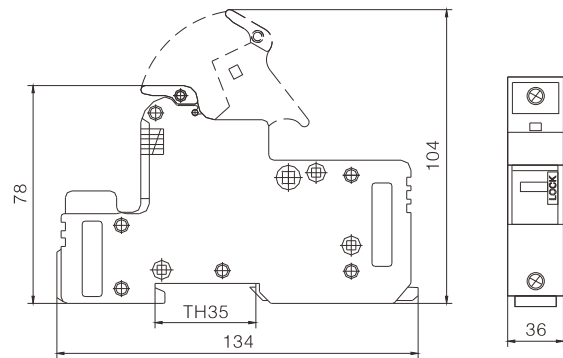

1500VDC/22x58B/50A

# PHOTOVOLTAIC FUSE

**1500VDC/H3L 125A-500A**



## Photovoltaic Fuse

- Class of Operation: gPV
- Standard: GB/T 13539.6 IEC 60269-6
- Breaking Capacity: 30kA
- Time Constant: 1-3ms

## Dimensions(mm)

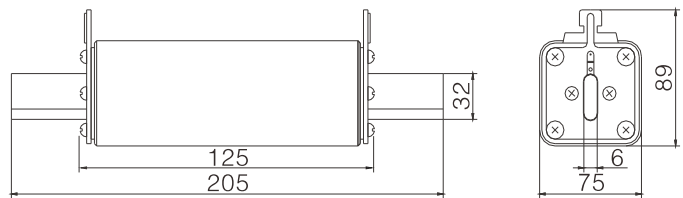

1500VDC/H3L

**1500VDC/H3LB**



## Photovoltaic Fuse

- Rated Voltage: 1500V .dc;
- Class of Operation: gPV
- Standard: GB/T 13539.6 IEC 60269-6

## Dimensions(mm)

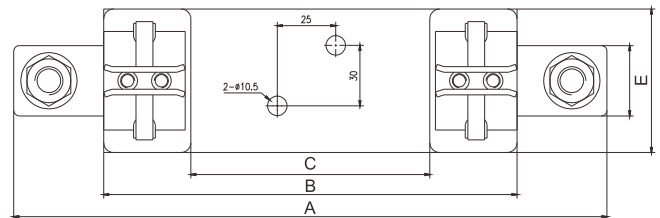

## Specifications

Model	Applicable fuse link	Rated voltage (V)	Rated current (A)	Overall dimension/size				
				A	B	C	E	H
1500VDC/H3LB/630A	1500VDC/H3L/630A	1500VDC	630	300	210	135	63	108